

CHOOSE YOUR OWN WILKES ADVENTURE

FIRST-YEAR STUDENT

ORIENTATION

2024

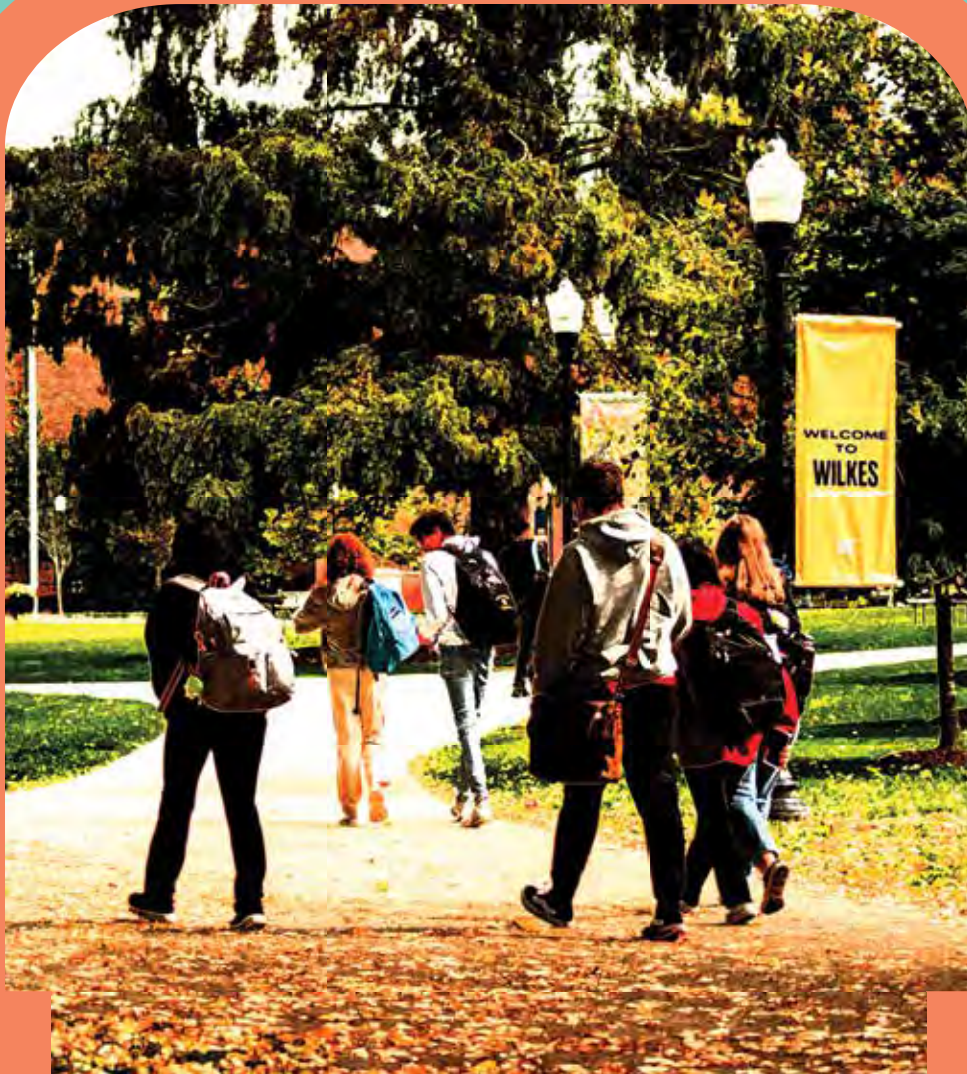

Wilkes University

ORIENTATION SCHEDULE

YOUR ADVENTURE BEGINS:

ARE YOU A WIZARD WITH TECH? DO YOU HAVE A PENCHANT FOR HEALING AND ELIXIRS? ARE YOU A FIERCE PLAYER ON THE FIELD? DISCOVER A WORLD OF WHIMSY AND WONDER BECAUSE WHEN IT COMES TO ADVENTURE, AT WILKES, YOU WILL.

8 AM - REGISTRATION, FIRST FLOOR CONCOURSE, HENRY STUDENT CENTER

Your epic story begins here! Enjoy breakfast and refreshments to fuel up for your journey. No use in exploring on an empty stomach!

8:45 AM - WELCOME SESSION, DARLING THEATER, DOROTHY DICKSON DARTE CENTER FOR THE PERFORMING ARTS

President Greg Cant will welcome students and guests as you prepare to start your new adventure!

9 - 9:30 AM - FINANCIAL AID & BURSAR INFORMATION, DARLING THEATER, DOROTHY DICKSON DARTE CENTER FOR THE PERFORMING ARTS

Get to know your tools to *aid* in victory: The Office of Financial Aid will offer valuable information on understanding your tuition bill, payment and financial aid.

9:30 - 9:45 AM - STUDENT DISMISSAL, DARLING THEATER, DOROTHY DICKSON DARTE CENTER FOR THE PERFORMING ARTS

Map out your quest with Student Orientation Coordinator Morgan Steiner, who will introduce the 2024 team of e-mentors. The remainder of your day will be outlined with instructions.

It is here that your paths will diverge as students and guests have differing quests, but alas, you will come together again.

FAMILIES

9:50 - 10:50 AM - SETTING YOUR STUDENT UP FOR SUCCESS, DARLING THEATER, DOROTHY DICKSON DARTE CENTER FOR THE PERFORMING ARTS

Prepare your student for their journey to college life with a panel of staff from Campus Counseling, the Office of Academic Success, the Center for Career Development and Internships and the University Police Department. These seasoned wizards are ready to aid in any questions you may have!

STUDENTS

9:50 - 10:50 AM - SOCIALIZE THE WILKES WAE, MCHALE ATHLETIC CENTER, UNIVERSITY CENTER ON MAIN

Greet your new adventure buddies, the fellow Colonels and future classmates you will journey with during this exciting tradition hosted by Wilkes Adventure Education (WAE)!

STUDENTS

11 AM - NOON - MEET YOUR ACADEMIC ADVISOR - GROUP ADVISING SESSIONS, ASSIGNED CLASSROOMS (SEE YOUR NAME TAG FOR LOCATION)

Plot your semester! Meet your advisor! Get an idea of what your fall semester will look like from your assigned academic advisor. Schedule your individual appointment with your advisor at this time.

FAMILIES

11 AM - EMPOWER & SUPPORT: STRIKING A BALANCE FOR YOUR STUDENT'S COLLEGE SUCCESS, JEAN AND PAUL ADAMS COMMONS (JPAC), SECOND FLOOR, HENRY STUDENT CENTER

Learn how to support your student on their ultimate quest. Practical advice on the ins and outs of their mission, such as support during the transition to college, access to Wilkes news and events, etc. Work as a team to conquer the anxiety of the first semester!

FAMILIES AND STUDENTS

11 AM - 1 PM - LUNCH, THIRD FLOOR, HENRY STUDENT CENTER

Rejoin your party to enjoy lunch in the dining hall

**ADVISING APPOINTMENTS BEGIN AT 12:45 PM AND CONTINUE THROUGHOUT THE AFTERNOON*

NOON - 1:30 PM - RESOURCE FAIR, FIRST FLOOR, HENRY STUDENT CENTER

Resources abound! Make sure to take stock of all that's available to you at the Resource Fair. Take advantage of the support to make the journey to the fall as smooth as possible.

1 - 1:30 PM - GROW, CONNECT, CELEBRATE!, JEAN AND PAUL ADAMS COMMONS (JPAC), SECOND FLOOR, HENRY STUDENT CENTER

Join the Office of Diversity Initiatives to learn how our programs and services support you throughout your journey at Wilkes.

1:45 - 2:30 PM - RESIDENCE LIFE INFO SESSION, JEAN AND PAUL ADAMS COMMONS (JPAC), SECOND FLOOR, HENRY STUDENT CENTER

Gather around with the team from the Office of Residence Life to learn about living on campus, residence hall expectations and more! Every good story needs a setting!

OR!

1:45 - 2:30 PM - COMMUTER LIFE INFO SESSION, FARLEY 002, FARLEY LIBRARY

Ahoy Commuters! Map out your journey to the "castle" with Wilkes University Commuter Council leadership and their staff advisor to learn about commuting to campus, parking, and more!

2:30 PM - 3 PM - CAMPUS TOURS

Follow your quest guides, the e-mentor team, on the first floor of the SUB for a tour of the kingdom (campus).

3 PM - HENRY STUDENT CENTER, FIRST FLOOR

The first step of your adventure is done! Enjoy some hard earned loot (coffee and refreshments), wrap up the remainder of the programming and wait for your student. Plunder the Colonel Corner store for Wilkes gear, stop by the Career Center (located behind the Henry Student Center by the yellow hand chair) and converse with other adventurers and their guides! Thank you for choosing Wilkes, and best of luck to you, new explorer, as you find your way back to us in the fall!

GET ACQUAINTED - PAGE 4

GET SOCIAL - PAGE 7

GET RESOURCES - PAGE 8

GET READY - PAGE 16

MEET YOUR e-MENTORS!

WHO ARE THE e-MENTORS?

The Wilkes University e-Mentoring Program provides first-year students with one-on-one and small group access to students who have been in their shoes before! This unique Wilkes experience through mentorship aids new Colonels in their transition to college as well as to provide an extraordinary supportive environment for academic excellence and personal growth. An effective mentor understands that their role is to be dependable, engaged, authentic and tuned in to the needs of the mentee.



EDUARDO ABREGO
he/him
International Relations
& Political Sciences



MARA ADAMS
she/her
Mechanical
Engineering



AIDEN ALLEN
he/him
Communications
& History



BRENDA ARIAS
she/her
Hospitality
Leadership



ADAM BUTTERWICK
he/him
Mechanical
Engineering



SAMARA CAREY
she/her
Communication
Studies



LOGAN COLONNA
he/him
Marketing



VANESSA COYLE
she/her
Sports Management



HUNTER DAVIS
he/him
Accounting



BECCA EARNST
she/they
Marketing



LOGAN FISHER
he/him
Pharmacy



LIZZY FRANCO
she/her
Pharmacy



DARWIN GONZALEZ
he/him
Electrical
Engineering



LIAM HACKETT
he/him
Corporate Finance
& Accounting



LILY HEBDA
she/her
English & Secondary
Education



AIDAN HUNTER
he/him
Mechanical
Engineering



KYLIE JAYNE
she/her
Nursing



ANTHONY KEHS
he/him
Communication
Studies



RILEY KNAUB
he/him
Marketing



JUSTIN KREBS
he/him
Mechanical
Engineering



BEN KUBIC
he/him
History & Secondary
Education



MARY LIUT
she/her
Middle-Level Education
(Grades 4-8)



BRYNN MARLOW
she/her
Nursing



KALEI MCCOURT
she/her
Psychology



JAKE MIDDLETON
he/him
Biochemistry



GABBIE MOORE
she/her
Political
Science



LOURDES NAVARRO
she/her
Environmental
Engineering



ASHLEY O'CONNOR
she/her
Environmental
Engineering



SHIV PATEL
he/him
Chemistry &
Neuroscience



ARACELLYS PINEDA
she/her
Psychology &
Neuroscience



OZZIE PRIEBE
he/him
History &
Political Science



ALEXIS REEDY
she/her
Nursing



EMILY ROBERTS
she/her
Criminology
& Sociology



MORGANNE SEITZ
she/her
Pharmacy



MORGAN STEINER
she/her
Political Science,
International Relations
& History



JOHN TONDORA
he/him
Biology



ERIC TROUTMAN
he/him
Business
Management



OWEN WARD
he/him
Nursing



REAGAN WELDON PERI
she/her
Geology



KIM WHEELER
she/her
Pharmacy & MBA



DANIEL WILLIAMS
he/him
Mechanical
Engineering

HOW DOES THE e-MENTOR PROGRAM WORK?

The mentoring experience continues into Welcome Weekend and throughout the entire fall semester. e-Mentors provide information and resources available to students as they adjust to the University and college life, establishing a climate of trust, support and encouragement. e-Mentors are expected to communicate regularly with their mentees, but are not limited to electronic communication. Students often meet face-to-face for lunch or coffee, and mentee groups may attend campus events together as well.

PLAY TO WIN!

ORIENTATION BINGO

BINGO IS A CLASSIC WILKES UNIVERSITY TRADITION.

For your first on-campus Bingo, complete your Bingo card/ orientation checklist. For every item you complete, your e-Mentor will give you a sticker. Once it's complete, have your e-Mentor sign it!

Submit your completed checklist to the Information Desk on the first floor of the Henry Student Center after 3 p.m. for a chance to win a **32-inch TV and other prizes!** Remember, this is a cover-all game! We will be drawing for prizes at 3:30 p.m. – **you must be present to win!**

To keep up with information regarding Welcome Weekend, events on campus, contests, and e-Mentor group programming fun throughout the semester, make sure to follow our social media channels!

TIKTOK: @wilkesumentors
INSTAGRAM: @wilkesumentors
FACEBOOK: Wilkes U Mentors

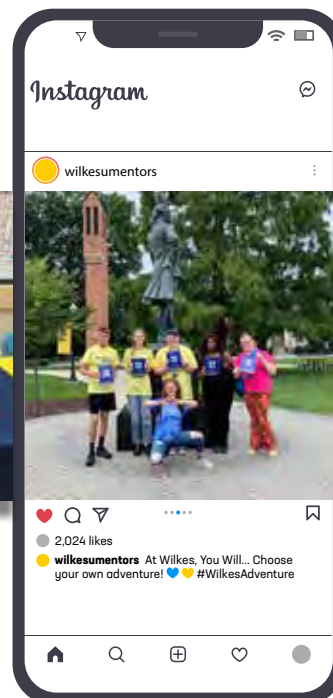

Tag us in your photos from Orientation and use
#WilkesAdventure
to share them with us!

GET SOCIAL!

BE IN THE KNOW BEFORE THE SEMESTER BEGINS! CHECK OUT SOME OF OUR MOST POPULAR INSTAGRAM ACCOUNTS:

@WILKESU

To keep up with special guests on campus, student spotlights, and other campus happenings, make sure to follow the official Instagram account for Wilkes University. You'll be kept up to date on just about everything you can think of, from upcoming performances, new academic opportunities, and more!

@WILKESCOLONELS

Are you already looking forward to showing your Colonel spirit at Wilkes sporting events? You'll definitely want to follow Wilkes University Colonels for all things athletics. This account promotes our Players of the Week, shares weekly game schedules throughout the year, and highlights all of the amazing things our student-athletes are up to.

WILKES MEGA COUNCIL CLUBS (check out page 26 for more)

@WILKESSG - Student Government

@WILKESUPB - Programming Board

@WILKES_MSC - Multicultural Student Coalition

@WILKES_COMMUTER - Commuter Council

@WILKES_RHC - Residence Hall Council

@WILKESU_DIVERSITY

Here at Wilkes, we strive to emphasize inclusivity among our students from all cultures and experiences; the Center for Global Education and Diversity Initiatives does an incredible job at showing it! To stay informed on guest speaker events, themed coffee hours, and informational sessions covering a wide variety of topics, make sure to keep up on Instagram.

@WILKESU_STUDEV

You'll never be bored on campus thanks to the lineup of trips and surprises planned by the Office of Student Development! By following along, you'll be the first to know about the next bus trip to NYC, pop-up scavenger hunt, acro-yoga session, or tee shirt giveaway in the SUB. Don't miss out!

@WILKESDINING

Yes, our Dining Services department is active on Instagram! The dining hall is known for holding holiday-themed specials, pop-up dessert stations in the SUB, and other delicious surprises. Check in frequently for specialty menus and other helpful information!

@WILKESUFIRSTDOG

Get ready to meet Walter, the "First Dog" of Wilkes University! When he's not sharing his latest adventures on Instagram, you can find him taking a morning walk with President Cant, or bringing the energy to an event on campus. He's super friendly, so make sure to say hello!



CHECK OUT THE RESOURCE FAIR

**JOURNEY TO THE FALL SMOOTHLY
...WITH HELP FROM THE RESOURCE FAIR
(1ST FLOOR OF HENRY STUDENT CENTER, NOON - 1:30 PM)**

- Academic Success
- Air Force ROTC/Army ROTC
- Bonner Leaders/Civic Engagement
- Bookstore/Colonels are Covered
- Bursar's Office
- Center for Career Development & Internships
- Commuter Council
- Counseling
- Dining Services
- DiscoverNEPA
- Esports
- Financial Aid
- Health & Wellness
- Honors & Scholars Programs
- Information Technology
- MicroFridge
- Multicultural Student Coalition
- Music Ensembles
- Office of Diversity Initiatives
- Parent & Family Portal
- PNC Bank
- Pre-Health Advising
- Programming Board
- Residence Life/Residence Hall Council
- Student Government
- University Police & Parking
- Work Study
- Writing Center



ACCESS YOUR CLASS SCHEDULE

To see your fall semester schedule after you've scheduled your classes with your advisor, visit the Wilkes Portal (portal.wilkes.edu) and follow these steps:

1. Log on to your portal.
2. Click on "Student"
3. Click on "Student Services"
4. Click on "My Registration"
5. Then, you can view your schedule in either block or detail format.

Block format is a visual option for viewing your schedule. It allows you to see gaps between your classes, and also lists the class sections, times, and meeting locations.

Detail format will tell you your classes in a list display. In addition to the class information that block format shows, detail format will also tell you the professor, amount of credits, and status of the class.

BLOCK FORMAT

Previous Week Week of May 08, 2023 (174 of 174)

	Monday	Tuesday	Wednesday	Thursday	Friday
9am					
		ART 298-A 10537 Class 9:15 am-10:59 am BEDFRD 212		ART 298-A 10537 Class 9:15 am-10:59 am BEDFRD 212	
10am	COM 203-IHA 10311 Class 10:00 am-10:50 am CSC 102		COM 203-IHA 10311 Class 10:00 am-10:50 am CSC 102		COM 203-IHA 10311 Class 10:00 am-10:50 am CSC 102
11am					
12pm					
1pm	IM 400-B 10558 Class 1:00 pm-2:15 pm BRB15 020		IM 400-B 10558 Class 1:00 pm-2:15 pm BRB15 020		
2pm					

DETAIL FORMAT

Adv. Principal of Interactivity - IM 303 - E

Associated Term: Spring 2023

CRN: 10556

Status: **Web Registered** on Oct 30, 2022

Assigned Instructor: Douglas S. Martin

Grade Mode: Normal Grading Mode

Credits: 3.000

Level: Undergraduate

Campus: Main

Scheduled Meeting Times

Type	Time	Days Where	Date Range	Schedule Type	Instructors
Class	6:00 pm - 8:45 pm T	Breiseth Hall 016	Jan 17, 2023 - May 13, 2023	Lecture	Douglas S Martin (P)

L.I.V.E./D2L

D2L, or L.I.V.E., as it is also known, is a website very important to Wilkes students. This is where you can view your classes, read announcements from professors, submit papers, take quizzes, access class resources and information, and much more!

Make sure to familiarize yourself with L.I.V.E. before your first day of class to ensure you know how to navigate it once the semester begins. You can access your own account at live.wilkes.edu. Your username and password are the same as your login credentials for the Wilkes Portal.

MAKE WILKES YOUR HOME!

COMMUTER LIFE

GETTING TO KNOW OTHER COMMUTERS

COMMUTER COUNCIL

Commuter Council is made up of officers and members all working towards the common goal of ensuring a fun commuter life and keeping you involved with campus happenings. All members are commuters, whether traveling from a nearby off campus apartment, or miles away. Topics such as parking for all the students on campus, socials and fundraising events, and community service opportunities are just a few of the many things that Commuter Council takes on. The council works closely with the Office of Academic Success, Student Government and the other Mega-Councils. Commuter Council organizes social and educational activities. Meetings will be posted at the beginning of each semester and will take place in the Commuter Lounge.

THE COMMUTER LOUNGE

The Commuter Lounge is located in the basement of the Eugene S. Farley Library, next to the Prayer Room. Students need to use their Wilkes ID to access the room. Hours for the lounge are 7 am - 10 pm. The Lounge provides a place for students to hang out in between classes and provides resources: 2 large conference style tables, 3 computers, a printer, dry-erase board, coffee and tea station, and a mini-fridge.

COMMUTER TIPS

WILKES ALERTS

Be sure to sign up for the Wilkes Emergency Alert on your phone. Students can sign up by logging onto their portal and clicking the red Emergency Notification System box on the right side of the screen. Follow the instructions to receive notifications about weather-related closings and other announcements.

ALWAYS BE PREPARED

CONSIDER KEEPING IN YOUR CAR:

- ☐ Umbrella
- ☐ Ice scraper/small snow shovel
- ☐ Hoodie/Jacket
- ☐ Change of clothes/shoes
- ☐ Phone charger
- ☐ Snacks/water bottle
- ☐ Tissues
- ☐ Blanket

OTHER COMMUTER ADVICE:

- Check your email before leaving to come to campus in case one of your classes got canceled, a professor sends a time-sensitive announcement, etc.
- Make sure to leave with extra time when coming to campus! Account for how long it takes to find a parking spot, walk through campus, and get to your classroom.
- Breaks between classes can be used for events, studying or down-time!
- Join clubs and organizations to get involved and find what you like to do.
- Check out all of the local spots to eat!

PARENT AND FAMILY PORTAL

Wilkes University has a great way to stay involved with your student and receive news from our school. Sign up for our parent portal using the QR code, if you are not signed up already! This portal is your one-stop shop for access to important campus news and deadlines, personalized newsletters on your schedule, announcements via email, and more!

RESIDENCE LIFE

I'M MOVING IN! WHAT SHOULD I BRING?

Save space for yourself and your roommate by packing only the essentials. Here are some things you will want to consider when packing up in August:

CONSIDER BRINGING:

- | | |
|------------------------------------------------------------------------|---------------------------------------------------------------------|
| <input type="checkbox"/> Bathrobe | <input type="checkbox"/> Laundry Supplies (basket, detergent, etc.) |
| <input type="checkbox"/> Bedding (sheets - twin XL, blankets, pillows) | <input type="checkbox"/> Microwave (strongly encourage to rent) |
| <input type="checkbox"/> Cleaning Supplies | <input type="checkbox"/> Shower Tote |
| <input type="checkbox"/> Command/3M Strips | <input type="checkbox"/> Snacks |
| <input type="checkbox"/> Computer | <input type="checkbox"/> Surge protected Power Strip |
| <input type="checkbox"/> Desk Lamp | <input type="checkbox"/> TV |
| <input type="checkbox"/> Fan | <input type="checkbox"/> Towels |
| <input type="checkbox"/> Flashlight | <input type="checkbox"/> Umbrella |
| <input type="checkbox"/> Garbage Can | <input type="checkbox"/> Vacuum |
| <input type="checkbox"/> Hangers | |

PLEASE LEAVE AT HOME:

- ✗ Air Conditioners
- ✗ Beer Pong and other alcohol paraphernalia
- ✗ Dart Boards
- ✗ Electric Blankets
- ✗ Extension Cords
- ✗ Pets
- ✗ Wick Burning Candles
- ✗ Toaster Ovens
- ✗ Other small appliances (air fryers, instant pots, blenders, etc...)

RESIDENCE LIFE STAFF

Worried about navigating res life? We're here to help.

Resident Assistants are assigned to each mansion or area of a residence hall to work directly with you, the residents. An RA is an undergraduate student who is trained in issues of crisis and conflict management, listening, and mentoring to help you navigate college life. They are experiencing college life with you, so reach out!

Residence Life Coordinators are professional staff members experienced in helping college students develop in their time on campus. These full-time staff members live and work in the halls to develop a community that will help you be successful. They supervise the resident assistants and work with Facilities to make sure everything is working correctly in your room. Here are some important contacts to keep handy:

CENTRAL OFFICE STAFF
reslife@wilkes.edu
570-408-4350
wilkes.edu/reslife

DIRECTOR OF RESIDENCE LIFE
Nicole Langan
nicole.langan1@wilkes.edu
570-408-4354

If you have any concerns, please visit our office on the second floor of the Max Roth Center.



DINING LOCATIONS

HENRY'S DINING HALL - Exceptional food, employees, and environments are at the heart of Henry's Dining Hall. We're serving a diverse international menu with frequent seasonal menu changes.



RIFKIN CAFE - Freshly prepared sandwiches, burgers and chicken sandwiches await you at Burgers + Fries (B+F) and Which Wich!

STARK LEARNING CENTER - Home to Greens to Go and the P.O.D. Market.

- **GREENS TO GO** - Featuring a selection of seasonal salad greens, toppings, proteins, and gourmet dressings for salads and wraps, our salad experts will carefully craft your selection to your exact specifications.
- **P.O.D. MARKET** - Combines the neighborhood corner store with modern conveniences right in the heart of campus. The P.O.D. market also features grab n' go options for breakfast, lunch, and dinner, including sushi!

STARBUCKS AT GAMBINI'S - Enjoy hand-crafted espresso beverages, refreshers, teas, and delicious pastries and sandwiches! We accept Starbucks gift cards, too!

Resident students select their meal plans at the time of completing their housing contract. To purchase a commuter meal plan, visit the **Wilkes Portal**. In the portal select Student Services, then Housing and Dining. If you are a commuter and wish to purchase a Colonel plan, send your emailed request to studentmeals@wilkes.edu. For more information, view our dining provider website and/or contact us by phone at 570-408-3993 or by email at studentmeals@wilkes.edu.

DINING FAQ'S

What plans are offered to commuter students?

Commuter students may choose from the Colonel plans offered to resident students, add only Dining Dollars/Flex Dollars to their account, or choose a Commuter Meal Plan. All commuter meal plans are available for purchase on the Wilkes Portal page under Student Services.

How do I keep track of the amount of Dining/Flex Dollars I have left?

You may check your dining/flex balance using the GET app at any time. Also, any Dining Services cashier will be able to tell you what your current balance is, or you may email studentmeals@wilkes.edu with your request.

If all of the Dining/Flex Dollars are not used at the end of the semester, can they be carried over to the next semester?

Unused Dining/Flex Dollars will be carried over from the Fall semester to the Spring semester, but are not carried over to the next academic year. At the end of the Spring Semester all unused Dining/Flex dollars will be eliminated, and are not refunded.

MEAL PLANS

FALL 2024 - SPRING 2025 MEAL PLANS

MEAL PLAN	MEALS PER WEEK	DINING DOLLARS PER SEMESTER	FLEX DOLLARS PER SEMESTER	PRICE PER SEMESTER
Colonel Gold	Unlimited	\$150	\$50	\$3,206
Colonel Gold Plus	Unlimited	\$150	\$100	\$3,258
Colonel Gold Premier	Unlimited	\$200	\$200	\$3,414
Colonel Blue	Unlimited (Mon-Fri)	\$100	\$50	\$2,795
Colonel Blue Plus	Unlimited (Mon-Fri)	\$100	\$150	\$2,899
Colonel Blue Premier	Unlimited (Mon-Fri)	\$100	\$250	\$3,055
Senior Value Plan	-	\$100	\$50	\$1,356
Commuter 30	-	-	-	\$290
Commuter 60	-	\$100	-	\$643

SUPPORT SERVICES

- FERPA
- The Office of Academic Success (Tutoring and Academic Support)
- The Center for Global Education and Diversity
- The Center for Career Development and Internships
- The Office of Student Development
- The Office of Alumni Relations
- Wilkes University Police Department
- Health and Wellness Services
- The E.S. Farley Library
- Information Technology Services
- Office of Human Resources - Student Work Study Jobs
- Wilkes University Bookstore
- Department of Athletics
- Writing Center
- Colonel Cupboard
- Colonel Closet
- Title IX - Elizabeth Leo

LIBRARY RESOURCES

The Eugene S. Farley Library, named in honor of the first president of Wilkes University, is located at the heart of the Wilkes campus at the corner of South Franklin and West South Streets. It is abundant with resources including over 175,000 print books, 250,000 e-books and more. Students can use the library for studying, researching or socializing. Students are able to access a variety of tech needs and have support from the help desk and several tools online.

The library houses several University resources centers including:

- The University Archives
- The Writing Center
- The Information Technology Help Desk
- Alden Learning Commons (available 24/7 during regular school hours and accessible via WIN swipe card system)

Library resources and services are available at wilkes.edu/library and by phone at 570-408-4250.

THE COLONEL CORNER

MORE THAN A BOOKSTORE

Serving as a one-stop shop right here on campus, The Colonel Corner is conveniently located right on the first floor of the Henry Student Center. The Colonel Corner will fulfill your needs ranging from supplies that are essential for success, to merch for showing off school spirit.

COLONELS ARE COVERED

We are excited to announce the “Colonels Are Covered” program for all first-year and undergraduate students, which provides free textbooks with tuition. Scan the QR code to find out more.



OFFICE OF ACADEMIC SUCCESS

The Office of Academic Success, located in Conyngham Hall, is a valuable resource for all students. Within our office, students are able to access a variety of resources including Academic Support and Advising Services that can help them on their academic journey.

Our Academic Support Services include

- Peer tutoring sessions
- One-on-one student skill building opportunities with a Learning Specialist
- Navigating declaring a major
- Support to all students and faculty within their designated colleges

The Office of Academic Success also houses our Disability Support Services. Disability Support Services (DSS) is committed to providing equal educational opportunity for all students who meet the academic admission requirements. In order to receive accommodations, students must provide appropriate documentation of their disability.



For more information, please contact katy.betnar@wilkes.edu.

To visit Academic Success Central for tutoring information, scan the QR code.

HEALTH & WELLNESS

PHYSICAL HEALTH

The Wilkes University Health and Wellness Services office provides routine health services for all students and is staffed by a certified registered nurse practitioner and a registered nurse. Its mission is to provide care, education and advocacy to improve the health and well being of its students. Referrals are made to local physicians as deemed necessary.

All students (on- and off-campus; full- and part-time), are eligible for health care and related counseling at the Health Services Office. Only emergency care will be provided to visitors.

MENTAL HEALTH

WILKES UNIVERSITY COUNSELING CENTER

PASSAN HALL, SECOND FLOOR

570-408-4100

Hours: Monday-Friday, 8:30 a.m. - 4:30 p.m.

Counseling is an opportunity for students to discuss personal concerns and explore ways of working through issues such as stress, anxiety, depression, grief, identity issues, eating issues, interpersonal conflicts and substance abuse. All undergraduate students (on-campus, off-campus, full-time and part-time) are eligible for free and confidential counseling. Counseling services are available both in person and via Telehealth. Students can schedule an appointment Monday through Friday, 8:30 a.m. - 4:30 p.m. by calling 570-408-4100. The Wilkes University Support Line 570-408-CHAT (2428) is also available 24/7 for any student in crisis. The CHAT line is staffed with skilled clinicians who are trained specifically in college student mental health.

BILLING & PAYMENT INFO

STUDENTS MUST HAVE FINANCIAL CLEARANCE BY AUGUST 12 TO BEGIN CLASSES FOR THE FALL SEMESTER.

Wilkes requires that all students obtain financial clearance at least two weeks prior to the start of classes or they may be deregistered. Financial clearance can be obtained in the following ways:

1. **Pay your balance in full.** Pay with an electronic check or credit card on the Wilkes portal at portal.wilkes.edu. Pay by check and mail to Wilkes University Student Lockbox, PO Box 824696, Philadelphia, PA., 19182-4696. Pay in person at the Bursar's Office in Miller Hall.
2. **Apply for and receive financial aid.** Have an approved financial aid award or loan that equals or exceeds the account balance for that semester.
3. **Enroll in our online installment payment plan.** The first installment is due on August 15 for Fall classes, January 15 for Spring classes, and June 1 for Summer classes.
4. **Submit a signed deferment agreement.** Submit a signed employer or third-party payment agreement, which includes payments from foreign governments. Forms are available on the student page of the Wilkes portal.

AUTOMATED PAYMENT PLAN

The Installment Payment Plan allows a student to pay the account balance monthly. Students may enroll at the beginning of each semester and installments are as follows:

Fall Semester	Five payments beginning on August 15
Spring Semester	Five payments beginning on January 15
Summer Semester	Three payments beginning on June 1

Once the bank account information is set up via the Wilkes portal, the University will automatically withdraw the interest-free payment from your account. Students can also add parents or other authorized users to receive notifications by selecting the "Authorized User" tab under payment area of the portal. All payment information is available via the parent page at wilkes.edu.

TO ENROLL:

- Sign onto the Wilkes website at portal.wilkes.edu
- Enter username and password
- Select "Student" tab > "Student Services"
- Under "Tuition and Billing", select "Payment Plans"
- Please follow instructions on the screen

The payment plan amount is calculated based on the balance at the time of enrollment. Any changes to registration will automatically change the payment amount. Emails will notify you of any payment changes. *Note: \$50.00 fee is charged to any student account in the event the University cannot process a payment installment.*

If you have questions, please call 570-408-4960. For login problems, please call the Help Desk at 570-408-4357.



ENSURE A SUCCESSFUL SEMESTER WITHOUT INTERRUPTION. CONTACT US TO DISCUSS YOUR FINANCIAL PLANS.

Bursar's Office

Miller Hall
32 W. South Street
570-408-4960
billing@wilkes.edu

Financial Aid Office

Capin Hall
165 S. Franklin Street
570-408-4512
financialaid@wilkes.edu

Incoming students should receive a pamphlet in the mail with options for financing your Wilkes education related to fees not covered by financial aid. For additional information and support, contact the Financial Aid Office.

View your invoice, make a payment, enroll in the payment plan or add an authorized user by visiting the "Tuition and Billing" section on the "Student Services" page of the Wilkes portal: portal.wilkes.edu

WORK STUDY 101

GAIN EXPERIENCE, EARN \$\$\$

Part-time employment opportunities exist both on-campus and off-campus through the federal work study and institutional work study programs.

FEDERAL WORK STUDY (FWS)

- Subsidized by the federal government
- Financial need based as determined by the FAFSA
- On-campus part-time jobs
- Off-campus approved community service part-time jobs
- Completed FAFSA verification requirements, if selected

VIEW JOBS AND APPLICATION PROCEDURES:
wilkes.edu/studentjobs

QUESTIONS? CONTACT:

Kimberly Mazur, Financial Aid Counselor
workstudy@wilkes.edu
570-408-5902

INSTITUTIONAL WORK STUDY

- Funded solely by the university
- Not required to demonstrate financial need
- On-campus part-time jobs

JOB APPLICATION AND NEW HIRE DOCUMENTS:
wilkes.edu/workstudyforms

Original forms of ID required - see form I-9 list of acceptable documents. Documents must be completed and approved prior to beginning work.

CENTER FOR CAREER DEVELOPMENT & INTERNSHIPS

We invite students to come to the Center for Career Development & Internships to start their Career Success Plan during their first year at Wilkes. We help students with deciding on majors, clarifying career goals, and exploring opportunities outside of the classroom. We assist with job/internship applications, interviewing, and resumes! Our Internship Director assists students in attaining cooperative education and experiential opportunities specific to their majors.

Wilkes University utilizes Handshake as a one-stop virtual platform for students to connect with employers, job/internship postings, Career, Internship, and Graduate School Fairs, as well as virtual events. The Center uses Handshake to engage students with our professional staff to support them in their career development.

THE CAREER GATEWAY PROGRAM

The first step in your career and professional development is participating in the Career Gateway Program, a master course that will be on their LIVE course listing, throughout your time at Wilkes. This program will help you to explore and articulate the career competencies that employers and graduate schools seek.

UNIVERSITY POLICE

THE WILKES UNIVERSITY POLICE DEPARTMENT PROVIDES A SAFE PLACE FOR MEMBERS OF THE CAMPUS COMMUNITY TO LIVE, LEARN, TEACH AND WORK.

We serve as the first responders and the primary safety resource for the Wilkes campus and our surrounding community. We currently have 10 police officers, 8 security officers and seven dispatchers on staff to provide 24 coverage, 365 days a year. Our services include:

CAMPUS PATROLS

Uniformed officers keep the campus safe by conducting around-the-clock patrols of University grounds and buildings. You will see us travel by foot, bicycle and vehicle. Members of the Wilkes University Police Department are always in full uniform and readily identifiable.

SAFE POLICE ESCORTS

Officers are prepared to escort and accompany students through campus at any time of the day or night. We also provide a safe ride to a wide area around campus through the Colonel Connector. Read more about the Colonel Connector below.

EMERGENCY REPORTING AND SECURITY MONITORING

50 emergency call boxes located around campus immediately connect members of the community to our 24/7 communications center. In addition, Wilkes has more than 170 closed-circuit cameras allow us to continually monitor public spaces on campus. Our Wilkes Shield safety app allows students to request emergency assistance with the click of a button. Read more about Wilkes Shield below.

EMERGENCY NOTIFICATIONS

By signing up for emergency alerts, members of the Wilkes community are notified by text and email of emergencies on and around campus in which they should be aware. Our text updates also announce school delays or closings in the event of inclement weather. Sign up for text alerts at wilkes.edu/campus-life/safety-security

FIRST RESPONSE

Each officer has been trained in emergency medical procedures, first aid and CPR. We collaborate with area first responders, including the Wilkes-Barre Police Department, to dispatch additional assistance as required.

Wilkes University police have arrest powers and serve as the primary law agency at the University. Minor offenses involving Wilkes students and University rules and regulations are referred to Office of Academic Success for disciplinary action.

The Wilkes University Police Department is located on the ground floor of 148 S. Main St.

In the event of an emergency, always call 570-408-4999 for assistance. Requests that are not an emergency, including questions about parking, can be requested by calling 570-408-4377.

SIGN UP FOR TEXT ALERTS

Visit wilkes.edu/wilkesalert or download Wilkes Shield in the App Store or Google Play.

WILKES SHIELD

Our safe campus just got even safer! Access safety tools and campus information by downloading the free Wilkes Shield app.

LET'S EXPLORE THE SAFETY APP

- Touching the Emergency button will open options for who you'd like to call. Touch either option to be connected.
- Immediate need for Police/Fire/EMS should be directed to 911. We monitor 911 Channel for calls and will respond.
- 911 calls made in our geo-fenced area on and around campus will send a message to our Communications Center.
- Do not "test" to see if the app is working – you will be connecting to 911!

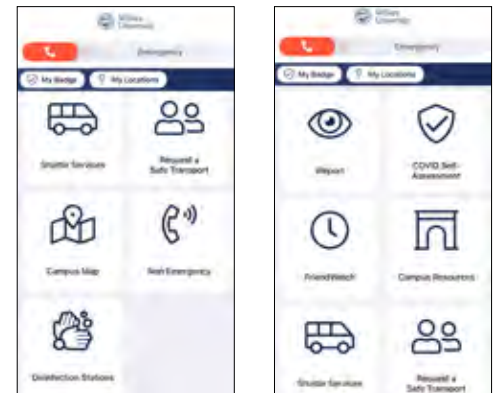

THE COLONEL CONNECTOR

The Colonel Connector provides campus members with safe transportation escorts to a wide area around campus and outside of the regular University shuttle hours. This service operates from 5 p.m. to 11 p.m., Monday through Friday, through the fall and spring semesters.

The Colonel Connector is a clearly marked Wilkes University van with flashing yellow lights, and is operated by a public safety officer. Each Wilkes campus member is permitted two guests that may ride with them from start to finish. Guests are required to present identification when boarding. For more information please visit: wilkes.edu/campus-life/safety-security.

PARKING

- All Wilkes lots are posted as either Faculty/Staff/Commuter lots or Resident Student Lots. Parking in any University lot requires a University Parking permit. Vehicles without permits are subject to ticketing and/or towing.
- Unless noted, the lots are open for parking without a permit after 4:30 p.m. until 7 a.m. the following day. Parking without a permit is also allowed on the weekends.
- Wilkes maintains a parking lot at the Ralston Field Athletic Complex. Shuttle service is available to and from the Ralston Field Lot Mon.-Fri. from 7 a.m. to 6 p.m.
- Students accounts are billed for outstanding violations. Repeated violations of campus parking regulations will result in the termination of parking privileges.
- The city has metered parking around the campus. They are responsible for the enforcement and maintenance of the meters.
- Questions about parking? Contact 570-408-7275

SPECIALIZED TRAINING

The Wilkes University Police Department offers SAFE Training to our students, faculty and staff. Developed by the National Self-Defense Institute, this training offers ways that members of the campus community can protect their personal safety. More than just a self-defense training, it addresses the skills needed to avoid, escape and survive a violent situation, heightening awareness and using instincts to defend yourself. Past students referred to the class as empowering, and that is our goal: to empower individuals should they ever find themselves in an unsafe situation.

The Department offers this training several times a year, specifically upon request of residence halls and various campus and community groups. If interested, please contact the Lieutenant of Support Operations at 570-408-4982.

GET INVOLVED @ WILKES!

YOU DON'T HAVE TO JOURNEY ALONE!

There are limitless possibilities when it comes to clubs and involvement on campus. You can pursue new interests, nurture old ones and find people to share them with.

BENEFITS OF INVOLVEMENT

- Eases the transition from high school to college.
- Explore and expand both new and old skills or interests.
- Expect to become a better leader, learner and citizen.
- Engage with other colonels who can become lifelong connections.

WAYS TO GET INVOLVED AT WILKES:

- Visit the Office of Student Development located on the first floor of the Henry Student Center
- Join Adventure Education and explore the outdoors
- Attend a concert, program and events on campus
- Volunteer with Civic Engagement and the Bonner Leader Program
- Talk your e-Mentor, RA or classmates
- Check Wilkes Today & your Wilkes email
- Colonel Guide
- Suitable – Student engagement platform and activities calendar



Go to wilkes.edu/campus-life/ to find out more.

CLUB DAY 2024

EXPLORE THE OPPORTUNITIES THAT AWAIT!

THURSDAY, SEPT. 5 • 11 AM - 1 PM (CLUB HOURS) • ON THE GREENWAY

Wilkes has 80+ clubs for you to join. From Equestrian to Fly Fishing, to Astronomy and WAE, Club Day is the best way to explore all the opportunities we have lined up. Come see what we have to offer!



CLUBS & ORGANIZATIONS

COLLEGE OF ARTS & SCIENCES

ARTS, SOCIAL SCIENCES

The Beacon

Chamber Orchestra

Choral Club

Civil Band

Criminology/Sociology Club

Games and Media Club

Kappa Kappa Psi

The Manuscript Literary Magazine

Pre-Law Society

Psychology Club

Sociology club

Speech and Debate

Studio 20

WCLH 90.7

WilkesNow! TV

The Writing Center

Zebra Communications

SCIENCES

Biology Club

Chemistry Club

Ecology Club

GeoExplorers

Math/Computer Science Club

Neuroscience Club

Pre-Professional Health Society

Pre-Vet Club

Women Empowered by Science (WEBS)

COLLEGE OF HEALTH & EDUCATION

NESBITT SCHOOL OF PHARMACY

Academy of Managed Care Pharmacy

American College of Clinical Pharmacy

American Pharmacists Association

Academy of Student Pharmacists

American Society of Health System
Pharmacists

Christian Pharmacists Fellowship
International

Lambda Kappa Sigma - Alpha Phi Chapter

Pennsylvania Pharmacists Association

Pre-Pharmacy Club

Rho Chi - Wilkes Pharmacy Honors Society
Student National Pharmaceutical
Association

PASSAN SCHOOL OF NURSING

Nursing Student Organization

Society of Student Nurses

SCHOOL OF EDUCATION

Education Club

COLLEGE OF BUSINESS & ENGINEERING

SIDHU SCHOOL OF BUSINESS AND LEADERSHIP

Finance Club

Hospitality Leadership Club

Investment Club

Students in free enterprise (SIFE)

ENGINEERING

Air and Waste Management Association

American Society of Mechanical Engineers

Engineering Student Activities Committee

Institute of Electrical and Electronics
Engineers

Pennsylvania Society of Professional
Engineers

Society for Automotive Engineers
(Mini Baja)

Society of Hispanic Professional Engineers

Society of Women Engineers

CULTURE AND DIVERSITY/ FAITH & SPIRIT

Black Student Union

Christian Fellowship Club

Friends of Panama

Hindu Spirituality Club

Indian Cultural Association

Multicultural Student Coalition

Student Organization of Latinos

Spanish Club

United Society of Buddhism

Wilkes Gender & Sexuality Alliance (GSA)

STUDENT ORGANIZATIONS

BACCHUS

College Democrats

Commuter Council

Future Business Leaders of America -

Phi Beta Lambda

Gold Bar Club

Honors Program Student Committee

Morgan's Message

National Alliance on Mental Illness (NAMI)

Programming Board

Residence Hall Council

Sports Management Club

Student Government

Student-Athlete Advisory Committee

COMMUNITY ENGAGEMENT

Alternative Spring Break (ASB)

Dance Marathon

UNICEF

Veteran's Council

CLUB SPORTS/SPECIAL INTEREST

Animal Welfare Club

Army ROTC (Through Kings College)

Cheerleading

Dance Team

Equestrian Club

Fly Fishing club

Golf Club

Running Club

Step Team

Tap Club

Wilkes Adventure Education

Wilkes Ski & Snowboard Club

Wilkes University Ultimate Frisbee Club

INTRAMURAL SPORTS

Flag Football

Indoor Basketball

Indoor Soccer

Indoor Volleyball

MEGA COUNCILS

STUDENT GOVERNMENT (SG)

Student Government serves as a sounding board for students' concerns on campus. SG formulates the student activities budgets and approves fund requests for all clubs. It also is responsible for the coordination of some of the largest events on campus and within the community. SG collaborates with the leaders of other prominent groups on campus to ensure that the best experience is available to our family of Colonels. Elections take place early on in the fall semester, so consider running for a position! **For more information, feel free to reach out to studentgovernment@wilkes.edu.**



PROGRAMMING BOARD (WUPB)

Wilkes University Programming Board is a great way for all students to get involved on campus. Help run and plan events such as bingos, giveaways, game show nights, Freak Week, concerts, and so much more! If planning events isn't for you, you can still participate in our fun events every Thursday night, so mark your calendars! **If you have any questions, please email wupb@wilkes.edu and scan the QR code to follow us on Instagram @wilkesupb!**

MULTICULTURAL STUDENT COALITION (MSC)

The Multicultural Student Coalition is a group of students dedicated to spreading diversity here on campus and in the Wilkes-Barre community. MSC looks to get students more involved in campus activities and collaborate with other MEGA Councils. Make sure to check out like the annual MSC Talent Show, the One World Party, speakers, and more! **For more information, email msc@wilkes.edu.**



COMMUTER COUNCIL (CC)

Commuter Council members all work towards the common goal of making commuter life fun and involved with campus happenings. All members are commuters, whether traveling from a nearby off campus apartment, or miles away. Topics such as student parking, socials and fundraising events, and community service opportunities are just a few of the many things that Commuter Council takes on. **If you have any questions, please email commuter@wilkes.edu.**

RESIDENCE HALL COUNCIL (RHC)

The Residence Hall Council consists of elected representatives from each campus residence halls. Its major function is to deal with the concerns of resident students—policy, parking, maintenance, etc.—and to present these concerns to the administration. RHC holds events such as Deck the Halls, Trivia Night, and Study Break. RHC also works closely with other MEGA councils to plan campus-wide social events and activities. All students are welcome to attend RHC meetings and/or serve as a member of one of its committees. For more information, feel free to reach out to rhc@wilkes.edu.



HONORS & LEADERSHIP PROGRAMS

**ARE YOU AN AMBITIOUS, MOTIVATED LEARNER STRIVING FOR
EXCITING ACADEMIC CHALLENGES?
THEN YOU WILL FIND THE WILKES UNIVERSITY HONORS
COMMUNITY A WELCOME HOME.**

BONNER LEADER PROGRAM & CIVIC ENGAGEMENT



Community service. Community collaboration. At Wilkes, these aren't just buzzwords. They're part of who we are as an institution, with students, clubs, athletics, faculty, staff and administrators all getting involved to better understand the root causes and interconnectedness between societal issues. We move students beyond volunteerism to understand the power of collaboration with community partners and help you make it a priority in your values and actions. Programs include Alpha Phi Omega, the Bonner Leaders and others.

In the Bonner Program at Wilkes, you'll commit to participate in this unique work-study experience that blends community service with enrichment and training activities. Students will be able to serve local and state-wide communities. The program provides financial support for your education, such as Federal Work Study opportunities and scholarships, and offers:

- cohort-based leadership development
- build capacity with community partners
- one-on-one mentoring throughout your four years.
- deadline to apply is spring semester of freshman year; currently accepting applications; students with community service experience encouraged



To find out more, visit wilkes.edu/bonner or contact Alicia Burns, Bonner Leader Program Coordinator, at alicia.burns@wilkes.edu or 570-408-3914.

HONORS AND BARRE SCHOLARS PROGRAMS

Are you a student looking for exceptional opportunities to set yourself apart from the crowd and challenge yourself academically? If so, then we invite you to explore Wilkes University's prestigious Barre Scholars Program. Focused on academic distinction and opportunity, these elite scholars will take advantage of enhanced educational offerings such as:

- faculty-led reading and research groups
- an escalating scholarship for as long as you remain in the program
- priority access to non-federal work-study opportunities
- They will also be eligible to apply for the Isaac Barre Prize for academic achievement in their graduation year.

Those invited to the Barre Scholars Program will be notified and must declare their intent to enroll.

Qualified students may participate in both the Barre Scholars Program and the Honors Program. Applications for the Honors Program have currently closed, when they are available, they can be accessed here: wilkes.edu/honors. To view qualifications, go to: wilkes.edu/academics. If you have any questions about the program, contact jennifer.mclaughlin1@wilkes.edu.



VISIT US ON
INSTAGRAM!



WHERE WILL WILKES TAKE YOU?

**THE NEIGHBORHOOD MIGHT BE RIGHT HERE IN WILKES-BARRE,
BUT WE HAVE TIES THAT REACH ACROSS THE GLOBE,
FROM PITTSTON TO PANAMA!**

NEPA NEIGHBORHOOD DESTINATIONS

- The Lands at Hillside Farms: Environmental Science 105
- Susquehanna Brewing Company: Environmental Science 105
- NEPA Community Service Projects: Habitat for Humanity and PAK Food Distributions, Civic Engagement
- Classroom Visits: Education Department
- Galen Glen Winery: Chemistry 398



STATESIDE EXPERIENCES

- Give Kids The World Village - Kissimmee, Florida: Honors Program
- Salem, Massachusetts: Commuter Council
- Corning Museum of Glass - Corning, New York: Chemistry Club
- THEREPS Conference - Las Vegas, Nevada: Hospitality Leadership
- Grand Canyon National Park, Arizona: Wilkes Adventure Education
- Mauna Kea, Hawaii: GeoExplorers Club
- Hawaii: Bonner Leaders
- Longmont, Colorado, and Washington, D.C., Alternative Spring Break



GLOBAL GETAWAYS

- Malaysia: Global Cultures
- Costa Rica: Political Science/Biology
- Scotland & Ireland: Political Science/History
- France: Chemistry
- Spain: Men's Soccer
- La Piedra, Dominican Republic: Alternative Spring Break



SORDONI ART GALLERY

STUDENT POWERED, SAG APPROVED



The Sordoni Art Gallery is a different kind of classroom. Our state-of-the-art exhibition space is where you can see art made by world-famous artists, learn things you never knew before from artists themselves, and even make your own creations during our various workshops and events. Our mission is to encourage an appreciation of the arts and an understanding of its role in society through direct engagement with art. Our main focus is to present high-quality exhibitions, related programming, and publications in a wide range of media, topics, cultures, and time periods.

Want to get involved? The easiest thing is by just walking through our doors. We host 4 exhibitions a year and are open 5 days a week. It's a great way to spend a few minutes in between classes. **Want to know more?** All of our events are free for students. Every lecture, workshop, and film screening is for you. We even host free yoga classes! Follow us on Facebook, Instagram, and Twitter @sordoniartgallery for updates.

Is that not enough? Maybe you want to join our staff! Students perform many roles at the gallery from gallery attendant, to social media ambassador, to student designer. You can get paid and support the arts at the same time! We are located in the Karambelas Center. Come visit!

For more information: visit wilkes.edu/sordoniartgallery or contact heather.sincavage@wilkes.edu with questions. Follow us on Instagram, Facebook, and Twitter @sordoniartgallery

WILKES ADVENTURE EDUCATION

Wilkes Adventure Education, or WAE, is experiential learning and strives to cultivate, encourage and develop self-awareness, hard and soft skills, environmental stewardship and an overall a sense of wellness. The program's objective is to introduce participants to fun, engaging experiences both indoors and outdoors so they may learn through trying, doing and practicing in a supportive culture. Adventure Education includes The Rock Wall and Ropes Course, and Adventure Series outings. **For more information, contact: jill.price@wilkes.edu**



WELCOME WEEKEND & MOVE-IN DAY

Welcome Weekend is a three-day program for all residential and commuter students prior to the first day of classes. Welcome Weekend acts as an extension of Orientation where students will attend informational workshops, socialize with their peers, and interact with campus leaders. Students can expect to get to know their campus with the help of their fall semester e-Mentor!

WELCOME WEEKEND COMMUNITY SERVICE - FRIDAY, AUG. 23

Incoming students will serve sites within the greater Wilkes-Barre/Luzerne County area. Students will be assigned either a morning or afternoon time slot.

Please visit wilkes.edu/welcome for the latest information on Welcome Weekend!

MOVE-IN DAY: THURSDAY, AUG. 22, 9 - 4 PM (TIMES WILL BE ASSIGNED)

For updated information about Move-in Day,
visit wilkes.edu/moveinday.

Before Welcome Weekend, make sure you have...

☐

Copy of health insurance card

☐

Two original forms of identification

☐

Up-to-date immunizations

☐

A completed housing contract

☐

A meal plan selected

☐

Residence hall/car necessities

☐

A parking permit, if applicable

STAY IN THE KNOW FOR THE YEAR AHEAD!



SCAN THE QR CODE
FOR THE 2024-2025
ACADEMIC CALENDAR.





ADMISSIONS

- 01 Oakes Hall

ATHLETIC FACILITIES

- 02 Buggsworth Field
- 03 Marks, Arnold C. Sports and Conference Center
- 04 Munson Field House
- 05 Sedgwick Stadium
- 06 Sedgwick Field
- 07 Sedgwick Field
- 08 Tennis Courts
- 09 McHale Recreation and Athletic Center

RESIDENCE HALLS

- 10 40 Ward (YNCA)
- 11 Monterey Hall
- 12 Cato Hall
- 13 Duane Hall
- 14 Evans Hall
- 15 Fortney Hall
- 16 Pharr Hall
- 17 Roper Hall
- 18 Ross Hall
- 19 Rohn Hall
- 20 Schenck Hall
- 21 Stinson Hall
- 22 Sterling Hall
- 23 Sturges Hall
- 24 Sullivan Hall
- 25 University Towers
- 26 Walter Hall
- 27 Weiss Hall

ACADEMIC BUILDINGS

- 28 Bedford Hall
- 29 Breckin Hall
- 31 Ceramics Studio
- 32 Cohen Science Center
- 33 Harold Cox Hall
- 34 Davis Center for the Performing Arts
- 35 Hokeback Hall
- 36 Kory Hall
- 37 95 W. South St.
- 38 Library, Duggins S. Farley
- 39 Stark Learning Center
- 40 Storms Center on Main
- 41 Kumbaska Media and Communications Center

ADMINISTRATIVE BUILDINGS

- 42 Chain Hall
- 43 Boone Center Campus Store
- 44 Corrigan Hall
- 45 Evans, Annella, Alumni House
- 46 Henry Student Center
- 47 Miller-Moore House
- 48 O'Neil Hall
- 49 Pissan Hall
- 50 Public Safety Office
- 51 Rohn, Max Center
- 52 Slocum Building
- 53 Westwood Annex
- 54 Westwood Hall
- 55 Miller Hall
- 56 Gordon Art Gallery
- 57 Career Development and Internships

PARKING LOTS

- 11 170 S. Franklin St.
- 12 180 S. Franklin St.
- 13 81 S. River St.
- 14 100 W. River St.
- 15 220 S. River St.
- 16 270 S. River St.
- 17 170 S. Main St.
- 18 180 S. Main St.
- 19 100 S. South St.
- 20 140 S. South St.
- 21 110 S. Main St.
- 22 110 S. Main St.
- 23 300 W. Northampton St., Edgewoodville
- 24 170 S. Main St.
- 25 170 S. Main St.
- 26 170 S. Main St.
- 27 170 S. Main St.
- 28 170 S. Main St.
- 29 170 S. Main St.
- 30 170 S. Main St.
- 31 170 S. Main St.
- 32 170 S. Main St.
- 33 170 S. Main St.
- 34 170 S. Main St.
- 35 170 S. Main St.
- 36 170 S. Main St.
- 37 170 S. Main St.
- 38 170 S. Main St.
- 39 170 S. Main St.
- 40 170 S. Main St.
- 41 170 S. Main St.
- 42 170 S. Main St.
- 43 170 S. Main St.
- 44 170 S. Main St.
- 45 170 S. Main St.
- 46 170 S. Main St.
- 47 170 S. Main St.
- 48 170 S. Main St.
- 49 170 S. Main St.
- 50 170 S. Main St.
- 51 170 S. Main St.
- 52 170 S. Main St.
- 53 170 S. Main St.
- 54 170 S. Main St.
- 55 170 S. Main St.
- 56 170 S. Main St.
- 57 170 S. Main St.
- 58 170 S. Main St.
- 59 170 S. Main St.
- 60 170 S. Main St.
- 61 170 S. Main St.
- 62 170 S. Main St.
- 63 170 S. Main St.
- 64 170 S. Main St.
- 65 170 S. Main St.
- 66 170 S. Main St.
- 67 170 S. Main St.
- 68 170 S. Main St.
- 69 170 S. Main St.
- 70 170 S. Main St.
- 71 170 S. Main St.
- 72 170 S. Main St.
- 73 170 S. Main St.
- 74 170 S. Main St.
- 75 170 S. Main St.
- 76 170 S. Main St.
- 77 170 S. Main St.
- 78 170 S. Main St.
- 79 170 S. Main St.
- 80 170 S. Main St.
- 81 170 S. Main St.
- 82 170 S. Main St.
- 83 170 S. Main St.
- 84 170 S. Main St.
- 85 170 S. Main St.
- 86 170 S. Main St.
- 87 170 S. Main St.
- 88 170 S. Main St.
- 89 170 S. Main St.
- 90 170 S. Main St.
- 91 170 S. Main St.
- 92 170 S. Main St.
- 93 170 S. Main St.
- 94 170 S. Main St.
- 95 170 S. Main St.
- 96 170 S. Main St.
- 97 170 S. Main St.
- 98 170 S. Main St.
- 99 170 S. Main St.
- 100 170 S. Main St.



WEST RIVER STREET

SOUTH RIVER STREET

SOUTH FRANKLIN STREET

NORTHAMPTON STREET

SOUTH MAIN STREET

BARBARIAN PLACE

SOUTH STREET

WASHINGTON STREET

