

## FAQ – ANDROID – HOW DO I CONNECT TO WILKES.EDU WIRELESS?

### Purpose

- This guide details the steps to connect to the Wilkes.edu wireless network using an Android device

### Requirements

- Active Wilkes account
- Android device

### Notes

- If your device is currently connected to a different Wilkes wireless network, you may first need to forget the connection. To forget a connection, keep your finger pressed on the connection you would like to forget, and when prompted, choose Forget Network
- When you change your Wilkes account password, you will need to update your device with your new password to avoid locking out your account

### Process

1. Swipe down on your unlocked phone to open the menu

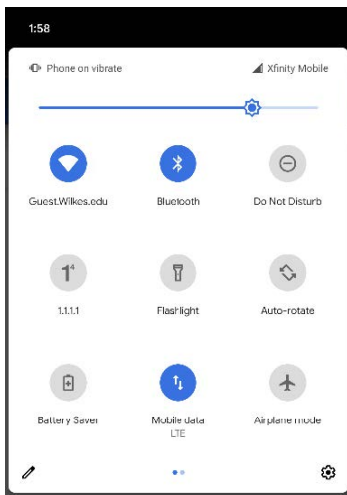

2. Press and hold the **WiFi** icon

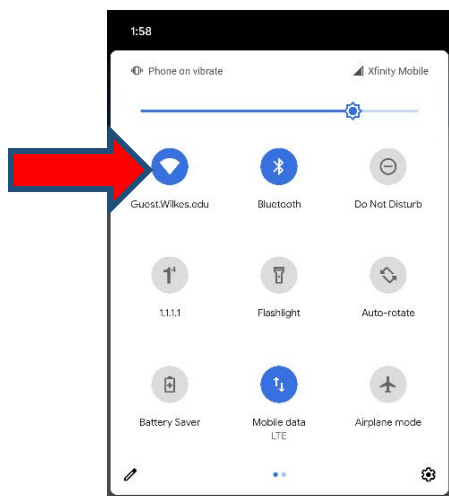

### 3. Find and select **Wilkes.edu**

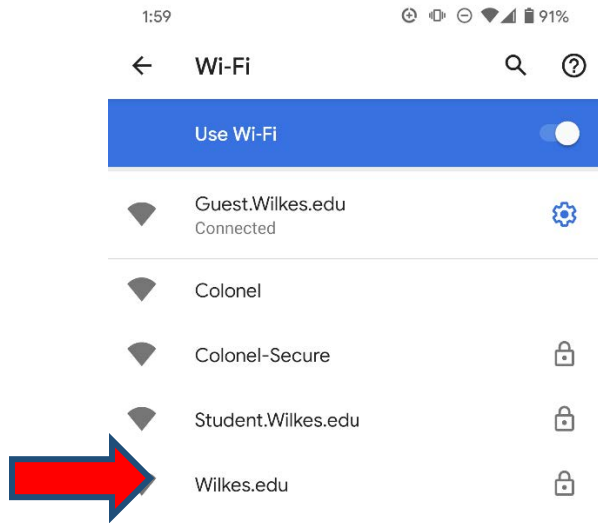

### 4. Select the **CA certificate** drop down and choose **Do not validate**

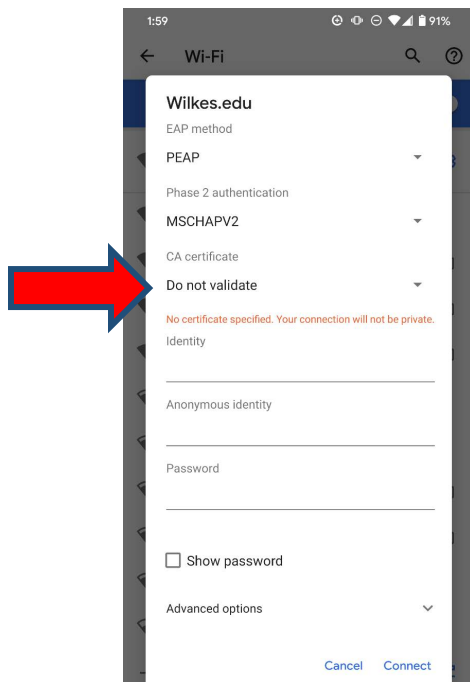

## FAQ – ANDROID – HOW DO I CONNECT TO WILKES.EDU WIRELESS?

5. In the **Identity** field, enter your Wilkes username. In the **Password** field, enter your Wilkes password. Choose **Connect**

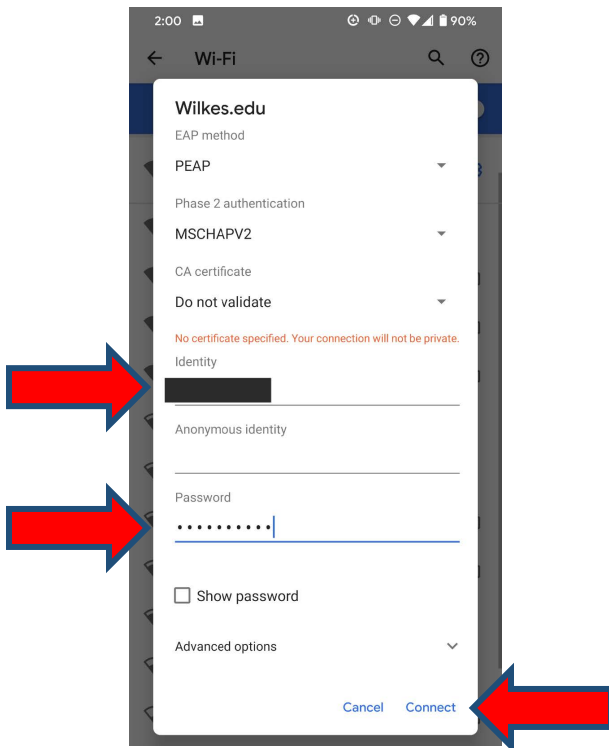

6. Your device is now connected to the Wilkes.edu wireless network

